



ED-VESA-A

Datasheet

by EDA Technology Co., Ltd

built: 2025-05-30

ED-VESA-A

VESA Wall-mounted Bracket



Specifications

Mechanical Characteristics	
Material	Sheet metal
Color	Black
Weight	About 265g
Max Load Capacity	20kg
VESA Hole Pattern	50mm/75mm/100mm
Clearance From The Wall	15mm
Fixing Method	Snap-on design
Installation	Wall-mounted

Dimensions



Clearance from the wall: 15mm

Ordering Code

Model	Description
ED-VESA-A	VESA Wall Mount Bracket for ED-MONITOR

Packing List

- 1 x ED-VESA-A (including 4 x M5*30 screws, 4 x M5*40 plastic expansion tubes, and 4 x M4*5 screws)

Installation

Parts List:

NO.	Name	Quantity (PCS)
①	ED-VESA-A	1
②	ED-MONITOR (Not provided)	1

Preparation:

You have acquired the tools, including an electric drill, a pencil, a hammer, a screwdriver, and other equipment.

Steps:

1. Separate the bracket's Base Plate and Panel.

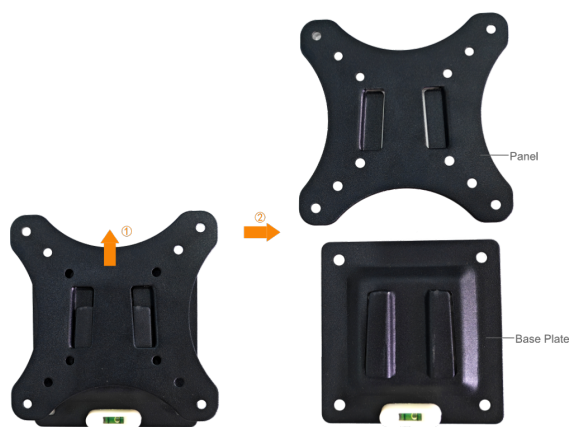

2. Mark the wall for drilling:

- ① Align the Base Plate with the wall.
- ② Use a pencil to mark the positions of the 4 screw holes on the wall, based on the screw hole spacing of the Base Plate.

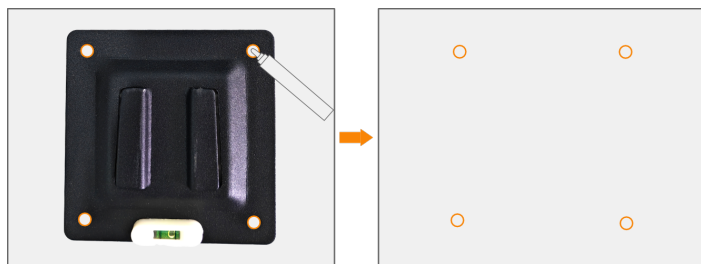

3. Drill and install Plastic Expansion Tubes:

- ① Drill 4 holes at the marked positions using an electric drill.
- ② Use a hammer to insert the 4 Plastic Expansion Tubes into the holes.

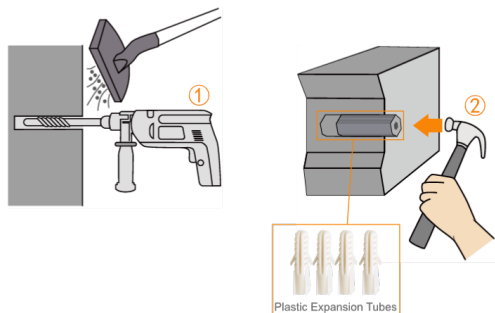

4. Secure the Base Plate to the wall:

- ① Align the 4 screw holes on the Base Plate with the installed Plastic Expansion Tubes.
- ② Insert the 4 mounting screws (M5*30) and tighten them clockwise with a screwdriver to fix the Base Plate firmly to the wall.

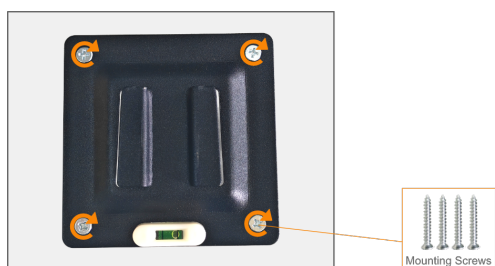

5. Attach the bracket Panel to the ED-MONITOR:

- ① Align the 4 screw holes on the bracket Panel with the 4 VESA mounting holes on the back of the ED-MONITOR.
- ② Insert 4 mounting screws (M4*5) and tighten them clockwise with a screwdriver to secure the Panel to the back of ED-MONITOR.



TIP

The VESA hole spacing for the ED-MONITOR is 75mm.

6. Mount the monitor onto the Base Plate:

- ① Lift the ED-MONITOR (with the bracket panel attached) and align the snap-on slots on the bracket Panel with the Base Plate.
- ② Press firmly to lock the Panel into the Base Plate installed on the wall.